



THE

# INTERIOR ANGLE

2012 Fall Seminar  
Information [Page 30](#)



## KAPS 2012, SUMMER ISSUE

KENTUCKY ASSOCIATION OF PROFESSIONAL SURVEYORS  
SUMMER 2012 – ISSUE 3

Photo Provided By Don Pedigo



### ADVERTISEMENT POLICY

*The Interior Angle* is the official publication of the Kentucky Association of Professional Surveyors (KAPS). It is published quarterly for the purpose of communicating with the professional surveying community, related professions and others with an interest in surveying. *The Interior Angle* is financed primarily by membership dues although advertisements are welcome from service and product industries relating to the needs and activities of the profession. *The Interior Angle* is mailed to KAPS members and similar organizations on a complimentary basis.

Articles and advertisements appearing in this publication are not the policy of the association unless specifically so stated. The association does not assume any responsibility for statements made or opinions expressed in the articles, advertisements or other portions of this publication. Articles may not be reproduced in whole or in part without the written permission of the editor.

*The Interior Angle* welcomes and encourages comments, opinions and responses by readers. Letters should be addressed to:

Editor — The Interior Angle  
124 Walnut Street  
Frankfort, KY 40601

Letters must be signed and include a daytime telephone number. The name of the letter's author may be withheld if requested. Letters may be edited for clarity and length.

*The Interior Angle* is published quarterly by the Kentucky Association of Professional Surveyors. All advertisements contained within *The Interior Angle* are published as a service to readers. Their publication does not imply or express any endorsement or recommendation by KAPS. The rates are as follows:

Size	Per Issue/Per Year
Full Page	\$175.00/\$600.00
1/2 Page	\$100.00/\$350.00
1/4 Page	\$65.00/\$225.00
Business Card	\$50.00
Business Card (KAPS Member)	\$25.00
Classified	\$40.00
Classified (KAPS Member)	\$20.00

Corporate Members receive a free business card ad in every issue.

Publisher — The Interior Angle  
Colleen Comer Courtwright  
124 Walnut Street  
Frankfort, KY 40601  
(502) 695-2349 • (800) 866-3029  
E-mail: [ComerCourtwrightKAPS@gmail.com](mailto:ComerCourtwrightKAPS@gmail.com)

# TABLE OF CONTENTS

From the President's Desk	<a href="#">Page 4</a>
Buford L. Payne Scholarship	<a href="#">Page 6</a>
The Board Report	<a href="#">Page 8</a>
Board Calendar	<a href="#">Page 13</a>
KAPS Board of Directors	<a href="#">Page 15</a>
201 KAR 18:192 Continuing Education	<a href="#">Page 20</a>
Right from the Beginning	<a href="#">Page 26</a>
Fall Seminar Schedule	<a href="#">Page 30</a>
2012 KY GIS Conference	<a href="#">Page 33</a>
2013 KAPS Conference Info	<a href="#">Page 40</a>
Golf Outing & Picnic Photos	<a href="#">Page 42</a>

## KAPS WELCOMES

### NEW MEMBERS

Darrell Buttrick  
Northeast Chapter

Derek McNeely  
Northern KY Chapter

Monty Allen Turner  
Southeast Chapter

Ronald F. Willhoit  
Bluegrass-Capital Chapter

## KAPS 2012 Officers & Directors

President . . . . . Donald Pedigo, PLS  
President-Elect . . . . . Thomas Clayborn, PLS  
Vice President,  
External Affairs . . . . . James Mayo, PLS  
Vice President,  
Internal Affairs . . . . . John Schneider, PLS  
Past President . . . . . Brian Cox, PLS  
Secretary . . . . . Bill Jones, PLS  
Treasurer . . . . . David Dummer, PLS, PE

### Ex-Officio Directors

Professional Development  
Chair . . . . . Don Pedigo, PLS  
NSPS Governor . . . . . Craig Palmer, PLS  
KY State Board of  
Licensure Liaison . . . . . Chris Gephart, PLS  
KSPE Liaison . . . . . Bob Westermeyer, PLS  
GIAC Liaison . . . . . Ted Niemann, PE, PLS  
KAMP Liaison (Non-Voting) . . . . . Steve Lily, PLS

### Directors

Tom Bushelman, PLS	Doug Comer, PLS, PE
Dave Dummer, PLS	Bob Fentress, PLS
Bill Jones, PLS	Thad Lucas, PLS, PE

### Chapter Chairs

Audubon . . . . . Mike Ladnier, PLS  
Barren River . . . . . Shaun Foley, PLS  
Bluegrass Capitol . . . . . Kevin Phillips, PLS  
Falls of the Ohio . . . . . Tim Chilton, PLS  
Green River . . . . . Bobby Miller, PLS  
Highlands . . . . . Johnny Justice, PLS, PE  
Jackson Purchase Area . . . . . Jonathan Payne, PLS  
Northeast . . . . . Mike Ruggles, PLS  
Northern Kentucky . . . . . Tim Ryan, PLS  
Southeast . . . . . Dempsey Miracle, Jr., PLS

### KAPS Office Staff

Molly Forrest, Administrative Assistant

An Affiliate of the American  
Congress on Surveying and Mapping and  
The National Society of Professional Surveyors

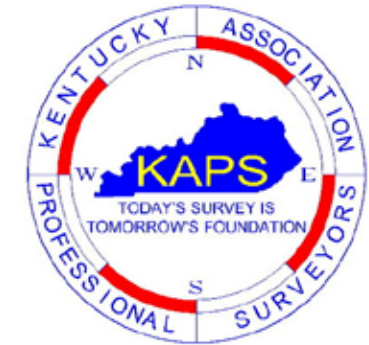

## KAPS 2012 Standing Committee Chairs & Co-Chairs

Annual Conference . . . . . Donald Pedigo, PLS &  
Bobby Miller, PLS  
Annual Picnic . . . . . Donald Pedigo, PLS  
Boy Scouts . . . . . James Robert, PLS  
By-Laws . . . . . Tom Bushelman, PLS  
County Surveyors . . . . . Richard Montgomery, PE, PLS  
Education . . . . . Dr. Ronald E. Gallagher, PLS  
Ethics & Professional Practice . . . . . Chris Gephart, PLS  
Finance . . . . . James Mayo, PLS  
GIS . . . . . Edmund "Moe" Miller, PLS  
Legislative . . . . . James Riney PE, PLS  
Membership . . . . . Robert Westermeyer, PLS  
Minimum Standards . . . . . Donald Pedigo, PLS  
Nominating . . . . . Executive Committee  
Past Presidents . . . . . Richey Newton, PLS  
Policy Manual . . . . . Tom Bushelman, PLS  
Professional Development . . . . . James Mayo, PLS  
or Chris Gephart, PLS  
Public Relations . . . . . Thomas Clayborn, PLS  
Publications / Newsletter . . . . . Doug Comer, PLS, PE  
Scholarship . . . . . John St. Clair, PLS

On the Cover:  
Aaron Cooley with QK4 lines  
up his putt at the KAPS golf  
outing on June 22nd at My Old  
Kentucky Home State Park.



**Don Pedigo, PLS**

Kentucky Association of Professional Surveyors  
124 Walnut Street • Frankfort, Kentucky 40601

# FROM THE PRESIDENT'S DESK

## SUMMERS HERE AND IT'S HEATING UP

I am enjoying my term as President. This year has gotten off to a great start as our legislative efforts paid off with the signing of the County Surveyors bill. Thanks to the efforts of Mr. Richard Montgomery, the membership and your KAPS leadership! – **GREAT JOB!!**

KAPS is moving in a positive direction and we intend to keep the momentum moving forward! We continue to make changes that allow KAPS to be more efficient and more up to date. As you know we have updated the KAPS website, it is up and running and we have had some very positive feedback. You can now register for events online as some of you did for the golf outing and picnic. We had some minor hiccups along the way with registration which is to be expected but nothing that could not be fixed quickly. Our launch of the new website is a big step in a positive direction and one that will allow us to operate the association more efficiently and ultimately more effectively for the membership.

Another positive change is our move into a larger office space adjacent to the current office. As directed in our April board meeting, we negotiated the rent and contract for the new office space. The move took place on Thursday, June 28 with the help of members Kevin Philips, Brad Eldridge, Rudy Garten, Nick Jerdon and Harry Girdler of the Bluegrass Chapter. Thank you!! One of the unique aspects of the move is that our address will not change as the new office is next



door to the old office. The owner of the building just switched suite numbers on the doors, and with the help of Molly got all the logistics worked out with the mail and utilities. It truly doesn't get much easier than that. Please stop by and see the new office when you are in Frankfort.

Part of the pleasure of being President is meeting the KAPS membership and visiting with the various Chapters around the Commonwealth. I want to visit all ten Chapters in 2012. **If you have a particular meeting or function you would like for me to attend, please let me know as soon as possible so I can get it on my schedule.** We depend on the Chapter Chairs to help keep the membership informed of what is going on at the State level and with the workings of the KAPS Board. Please keep up the good work.

### **SAFETY!**

I have talked a lot about safety and will continue to do so in 2012. Please take some time to reflect on your operations and field procedures while working in the rural areas or on our busy highways. While all the lights, signs, cones, vests, and well founded precautions cannot stop an accident, they certainly reduce the chances. With the summer heating up, make a concerted effort to stay hydrated and to work safely in the hot sun. This is a perfect time to take a moment to discuss safety with your employees and survey

crews, ask and/or remind them to take the time to think about safety and to be acutely aware of their surroundings at all times. ***"Be Careful out there!"***

The following is a brief review of activities since the March issue of *The Interior Angle* and our April 14th board of Directors meeting:

**2012 KAPS Annual Golf Outing and Picnic** – KAPS held our annual golf outing and picnic on June 22<sup>nd</sup> and 23<sup>rd</sup> at My Old Kentucky Home State Park golf course and the Wickland Historic Mansion (Home of three governors) in Bardstown, Kentucky. The success of both events was made possible by the hard work of Molly Forrest, Cathy Pedigo, Thad and Mariana Lucas (kid's events and games orchestrator), Jon Payne and Richard Montgomery (organizers of the survey completion). Thank all of you for a "JOB WELL DONE". Please read the article in this issue of *The Interior Angle* for photos and more information about the Golf Outing and Picnic.

**2013 KAPS Conference** – The 2013 conference is rapidly approaching, with the dates set for February 20<sup>th</sup> through the 23<sup>rd</sup>. The conference will be held at the Marriott Louisville Downtown hotel and convention center. The hotel and convention center are new, accessible and near all of the downtown attractions. The convention center has been very accommodating to our needs and I believe everyone will enjoy it! In an effort to get the best deal possible, the conference committee was able to negotiate a two year deal with Marriott. The 2014 conference will be held at the Griffin Gate Marriott Resort and Spa in Lexington on February 19<sup>th</sup> through the 22<sup>nd</sup>.

**Fall Seminars** – The 2012 fall seminars are right around the corner. If you would like a seminar in your area in the future, let us know so we can begin the planning, but be prepared to help. We need suggestions for topics and seminar locations. Please take minute to look over the 2012 schedule and make suggestions/recommendations for 2013 and future seminars. Spread the word about the quality of the

seminars KAPS presents to members and non-members that need the continuing education or just want to attend a worthwhile seminar to learn about new surveying technology, forensics, business and/or surveying standards.

**Proposed Easement Regulation** – Easement regulations have been discussed for quite a long time. At the direction of the Board of Licensure survey committee, the Board staff and legal counsel drafted some preliminary language. The proposed draft is a result of research along with communications with several utility companies by the board of licensure staff. I have appointed a committee to review the information we have been provided. This review and coordination process is arduous and will take considerable time and effort to work through.

**Legislative Session** – Our legislative committee and Government Strategies, LLC have met and together we are working on the 2013 legislative session strategies.

**Plat Law Legislation** – As reported by the KAPS Legislative Committee in previous board and committee meetings, the decision was made to draft some simple plat law language and introduce it in an attempt to see where, if any, the opposition is to a plat law. The concept of a plat law has been reviewed and approved in concept by the KAPS board and legislative committee. Mr. Bob Fentress and I attended the board of licensure survey committee meeting on April 05 to discuss it further with their committee. It was discovered that similar language was introduced in 1990 to the legislature and was partially successful. From what I understand, the bill had similar circumstances as our statute of limitations bill. We are currently reviewing the 1990 language to see how it can be improved to address previous concerns. A committee will be formed to make recommendations to the board before going forwards.

**Statute of Limitations** – KAPS proposed amendment to KRS 413.140, Statute of Limitations bill was sponsored by Representative Brent Yonts. The bill places licensed surveyors under the one year statute of limitations for

professionals. This bill made it to the Senate Judiciary Committee with no opposition in the 2012 session before it and we ran out of time for passage. We will try again next session.

Practice of Surveying Exam – NCEES announced June 14 that the Practice of Surveying (PS) exam is to become a closed-book exam in April 2013. At this time, examinees will use NCEES-supplied references during the exam and will no longer be allowed to bring other reference materials into the exam room.

Molly continues to do a great job for us in the KAPS office! Please take a minute to call her or even better yet stop by the new KAPS office to meet and get to know her.

In closing, thank you for the opportunity to serve you. I promise that I will continue to serve the membership and the Board of Directors to the

best of my ability. I will strive to achieve goals that we set and to keep KAPS and the surveying profession moving forward and in a positive direction. I look forward making new friends and to visiting with our membership throughout the year and will do my best to get new members involved in KAPS. Please don't hesitate to call or contact me.

Professionally and Sincerely,  
Don Pedigo, PLS  
KAPS President

DDS Engineering, PLLC  
148 Chester Court  
Bowling Green, Kentucky 42103  
270-843-2247 (Work)  
270-783-1071 (Cell)  
dpedigo@ddsengineering.com (Work)  
dpedigo@SCRTC.com (Home)

THE NORTHERN KENTUCKY CHAPTER OF THE KENTUCKY ASSOCIATION OF PROFESSIONAL SURVEYORS IS PROUD TO ANNOUNCE THE ESTABLISHMENT OF THE BUFORD L. PAYNE SCHOLARSHIP.



The Buford L. Payne Scholarship was established in honor of Bud Payne, a distinguished Civil Engineering Technologies advisory board member, co-op employer, and practicing surveyor, to provide funds for civil engineering technologies students who have taken full advantage of their co-op experience. Bud's passion for the civil engineering and surveying professions has impacted the students he has taught through co-op and the lives he has touched through his dedication to Cincinnati State's program and the projects he has been involved with.

Thank you for your years of dedicated service to our profession,  
Tim Ryan, Chairman NKY Chapter of KAPS.



# Introducing the Carlson SUPERVISOR + GPS Tablet



**Use it everywhere:**

- In the field • In the office
- In your car or truck

**You'll get:**

- A powerful, rugged PC tablet with a large 7" wide, easy-to-read display
- Integrated high-precision GNSS receiver
- Wireless support: BlueTooth, 802.11, GSM and CDMA
- Ability to start with base unit (works with existing receivers) & upgrade
- 0% lease financing available
- Option for a 3-year no-questions-asked replacement warranty

**Find Out More NOW!**

Visit your local Carlson dealer or call your regional Carlson representative  
**800-989-5028 • www.carlsonsw.com**

**Choose Your Application:**  
Carlson SurvPC or  
Grade Supervisor  
or BOTH!



World's most flexible & powerful data collection software

Easy-to-use software for construction grade management



## B. David Cox, Executive Director

Kentucky State Board of Licensure for Professional Engineers and Land Surveyors  
 Kentucky Engineering Center, 160 DEMOCRAT DRIVE • Frankfort, Kentucky 40601

# THE BOARD REPORT

April 2012

### Board Members

Governor Steven L. Beshear has appointed Jim Riney, PE, PLS and Mike Ritchie, PE, PLS to the Board. We welcome both gentlemen and look forward to working with them to protect the citizens of the Commonwealth of Kentucky and to advance the honored professions of engineering and surveying. We also want to thank outgoing Board members Steve Gardner, PE and Dennis Smith, PE, PLS for their service.

### Computer Based Testing

At the August 2010 NCEES annual meeting, member boards voted to convert the FE and FS exams to computer based testing (CBT) from the traditional paper and pencil method. This vote followed an intensive study by a task force convened to research the issue. CBT will allow greater scheduling flexibility and enhanced exam

security.

The last paper and pencil FE and FS exams will be given in October 2013. CBT will begin in January 2014. Applicants will be able to take the test anytime during four testing windows throughout the year. They will also be able to take the exam at Pearson VUE testing centers with over 300 locations throughout the United States. Convenient testing centers for Kentucky applicants are located in Lexington KY, Louisville KY, Cincinnati OH, Evansville IN, Nashville TN, Knoxville TN, Johnson City TN, and Charleston WV.

The current plan is to also transition the PE and PS exams to CBT. No specific dates have been determined for these exams.

For further information, please visit <http://cbt.ncees.org/>

### Historical Exam Pass Rates

Below are the pass rates for the national engineering and surveying exams since 2001:

Year	PE Exams	Pass	Pass Rate	FE Exams	Pass	Pass Rate
2001	287	137	48%	319	235	74%
2002	286	138	48%	319	223	70%
2003	297	142	48%	362	270	75%
2004	269	131	49%	336	227	68%
2005	253	121	48%	368	228	62%
2006	239	123	51%	336	219	65%
2007	255	136	53%	401	278	69%
2008	240	126	53%	369	242	66%
2009	245	135	55%	444	326	73%
2010	292	163	56%	434	297	68%
2011	268	160	60%	461	306	66%



Start at the tripod and never look back.

## TRIMBLE S6 Robotic Total Station

Back and forth." Easily two of the most hated words for any surveyor. Except perhaps "again".

Trimble® VISION™ technology brings new efficiency to the Trimble S6 by removing trips back to the tripod. Now you can see everything the instrument sees from your controller.

- Save time and effort by reducing set ups.
- Use your controller to remotely aim, acquire, and capture the measurements to reflectorless surfaces - at more than twice the distance you're used to.
- Video streaming with point overlays confirms your task list and still imaging provides you visual verification for all data before leaving the site.

Trimble VISION is the latest in a long line of innovations designed to make surveying more efficient, in the field, in the office, and wherever the next opportunity takes you. Find out more at [trimble.com/trimbleS6Vision](http://trimble.com/trimbleS6Vision)



© 2012, Trimble Navigation Limited. All rights reserved. Trimble and the Globe & Triangle logo is a trademark of Trimble Navigation Limited, registered in the United States and in other countries. Trimble Access is a trademark of Trimble Navigation Limited. All other trademarks are the property of their respective owners. SUR-206

**FOR MORE  
INFORMATION CALL  
YOUR TRIMBLE DEALER**

**Precision Products**  
Louisville, KY  
502-459-1900

**Precision Products**  
Lexington, KY  
859-225-3477

Year	PS Exams	Pass	Pass Rate	FS Exams	Pass	Pass Rate
2001	76	43	57%	105	34	32%
2002	46	20	43%	93	34	37%
2003	53	23	43%	77	21	27%
2004	48	20	42%	77	24	31%
2005	36	14	39%	97	36	37%
2006	42	19	45%	84	40	48%
2007	48	25	52%	83	33	40%
2008	44	26	59%	71	39	55%
2009	50	26	52%	55	32	58%
2010	34	20	59%	55	25	45%
2011	25	12	48%	72	32	44%

**ENFORCEMENT ACTIONS SUMMARY**

**For The Period  
January 14, 2012 – April 6, 2012**

CHAD WHITAKER  
ALPHA OMEGA INNOVATIONS, LLC

In December 2010, the Board of Licensure received information that Chad Whitaker, a licensed Landscape Architect from Taylorsville, had engaged in the unlicensed practice of engineering in violation of KRS 322.020 and KRS 322.060, through his company Alpha Omega Innovations, LLC. It was determined that Mr. Whitaker had offered professional engineering and land surveying services through the company website and business letterhead. Mr. Whitaker is not licensed as a professional engineer or land surveyor and Alpha Omega Innovations, LLC is not a permitted engineering or land surveying business entity. Upon being contacted by the Board, Mr. Whitaker agreed to correct the website immediately and agreed to an injunction enjoining Mr. Whitaker from further unlicensed practice until he becomes licensed by the Board. The Agreed Injunction also prohibits Alpha Omega Innovations, LLC from offering or providing engineering or land surveying services until such time as it obtains the appropriate Business Entity Permit from the Board. No penalties were assessed for the current violations; however the Agreed Injunction calls for a fine of \$2000 and

seven (7) days in jail for Mr. Whitaker and a fine of \$5000 for Alpha Omega Innovations, LLC for any future violation. The Agreed Injunction was entered in the Franklin Circuit Court on January 20, 2012.

ROBERT L. SMITH, PLS  
LAND MANAGEMENT SERVICES

On January 13, 2012 Robert L. Smith, PLS of Russell Springs entered into a Consent Decree with the Board of Licensure in settlement of a disciplinary action. Among other things, the Consent Decree required that Mr. Smith apply for a Business Entity Permit for his firm, Land Management Services. Mr. Smith failed to file the application within the time specified. In accordance with the terms of the Consent Decree and after being notified of the default, Mr. Smith's professional land surveying license was suspended effective February 9, 2012. Mr. Smith subsequently filed the application and his license was restored to active status effective February 10, 2012.

KIM C. FINCH, PE

In February, 2012 the Board of Licensure filed formal disciplinary charges against Kim C. Finch, PE of Lexington for failing to respond to an audit of his Continuing Professional Development credits. Prior to a hearing and by agreement of the parties, the matter was resolved

through a Consent Decree wherein Mr. Finch acknowledged the violation and surrendered his professional engineering license. The Board accepted the Consent Decree on April 6, 2012.

ZANE C. ALEXANDER, PE, PLS

In November 2011, the Board of Licensure brought a formal disciplinary action against Zane Alexander, PE, PLS of Salt Lick; alleging that Mr. Alexander had aided and abetted the unlicensed practice of former licensed land surveyor Donald R. Roberts. Prior to a hearing and by agreement of the parties, the matter was settled through a Consent Decree in which Mr. Alexander acknowledged the violation and agreed to the following sanctions: (1) a \$1000 fine, (2) suspension of his land surveyors license for 60 days, (3) completion of a class in the Standards of Practice within 6 months, and (4) completion of the New Mexico State University course in Surveying Ethics within 6 months. The Board approved the Consent Decree on April 6, 2012. R. G. VANDERWEIL ENGINEERS, LLP

In November 2011, the Board of Licensure investigated an allegation that R.G. Vanderweil Engineers, LLP of Boston, Mass. provided

**July 2012**

John Y. Walz, professor and department head of chemical engineering at Virginia Polytechnic University has been named the tenth dean of the University Of Kentucky College Of Engineering. He is scheduled to begin September 1, 2012. As the dean, he automatically has a seat on our board.

**Principles & Practice of Surveying Exam**

The Principles & Practice of Surveying ("PS") will become a closed-book exam in April 2013. At this time, examinees will use NCEES-supplied references during the exam and will no longer be allowed to bring other reference material into the exam room. There were two main reasons for the change. First, it increases security as a closed-book exam prevents candidates from copying exam questions into their references or bringing in prohibited items. Second, it will make for an easier transition when the PS exam moves to the computer based testing format.

engineering services to the University of Kentucky without first obtaining a Business Entity Permit. The matter was resolved by Consent Decree wherein the firm acknowledged the violation and agreed to pay a \$1000 penalty. Additionally the firm agreed not to solicit or provide engineering services in Kentucky in the future without first obtaining the required permit. The Board accepted the Consent Decree on April 6, 2012.

DANIEL BLAIN CLICK, PE

Mr. Daniel Blain Click, PE, of Irvine, was disciplined for a failing to make up a deficiency in his Continuing Professional Development (CPD) credits within 180 days as required by 201 KAR 18:196. The case was settled by a Consent Decree wherein Mr. Click the violation and agreed to the following sanctions: (1) a \$1000 fine, (2) submit proof of obtaining 30pdh of qualifying CPD credits to satisfy his obligation for calendar years 2009 and 2010 within 90 days, and (3) submit proof of obtaining an additional 30pdh of qualifying CPD credits to satisfy his obligation for calendar years 2011 and 2012 by not later than January 10, 2013. The Board accepted the Consent Decree on April 5, 2012.

**PE Exam for Software Engineering**

NCEES will begin offering a Principles & Practice of Engineering exam in Software Engineering in April 2013. It will be administered yearly thereafter. Partnering with NCEES as a co-sponsor of the exam is IEEE-USA, assisted by the IEEE Computer Society and the National Society of Professional Engineers and the Texas Board of Professional Engineers.

Groups representing software engineers have long maintained that software engineering should be licensed because it is increasingly practiced in areas that reach into the everyday lives of the general public, such as traffic control systems and the electric grid. For more information on the exam, please visit [ncees.org/exams](http://ncees.org/exams).

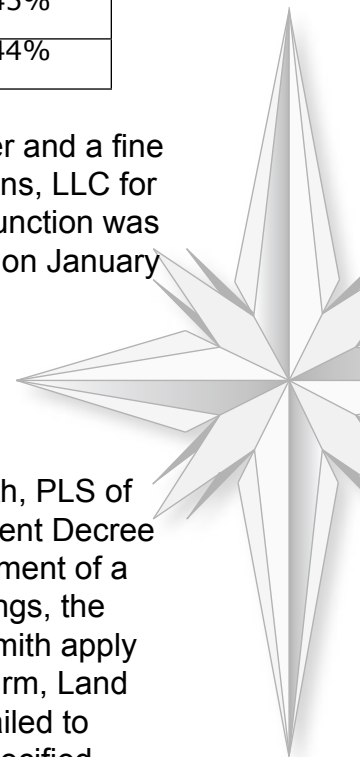

**ENFORCEMENT ACTIONS SUMMARY**

For The Period  
**April 7, 2012 – July 20, 2012**

A. SCOTT NIMON  
POWERSOURCE, LLC

In September 2010, the Board of Licensure received information that A. Scott Nimon, of Louisville, had engaged in the unlicensed practice of engineering in violation of KRS 322.020 and KRS 322.060, through his company Powersource, LLC. An investigation confirmed that Mr. Nimon had offered professional engineering through the company website, business cards and letterhead, and had provided engineering services to various industrial customers. Mr. Nimon is not licensed as a professional engineer in Kentucky and Powersource, LLC is not a permitted engineering entity. The matter was resolved through an Agreed Injunction wherein Mr. Nimon is to correct the website and is enjoined from further practice unless and until he becomes licensed by the Board. The Agreed Injunction also prohibits Powersource, LLC from offering or providing engineering services until such time as it obtains the appropriate business entity permit from the Board. No penalty was assessed for the current violations; however the Agreed Injunction calls for a fine of \$1000 and ten (10) days in jail for Mr. Nimon and a fine of \$2000 for Powersource, LLC. The Agreed Injunction was entered in the Franklin Circuit Court on July 12, 2012.

JESSE DEAN CRAFT, PE

Pursuant to 201 KAR 18:196, Mr. Jesse Dean Craft, PE, of Whitesburg was subject to an automatic audit of his Continuing Professional Development credits due to late renewal of his professional engineering license. The matter was referred to the Board's enforcement staff after Mr. Craft failed to respond to numerous audit notices. After numerous unsuccessful attempts by the enforcement staff to contact Mr. Craft, the Board filed formal disciplinary charges in accordance with KRS 322 and KRS 13B, charging him with violating 201 KAR 18:196 Section 9 (3). Mr. Craft did not answer the charges and did not

participate in the disciplinary hearing process. Upon recommendation of the hearing officer, the Board issued a Final Order revoking Mr. Craft's professional engineering license effective July 24, 2012.

WALTER L. BOWMAN, PE, PLS

In 2010, the Board of Licensure received information that Robert Taylor, a former licensee from Glade Spring, Virginia had begun work on a permit application for a coal mine in southeastern Kentucky, and that Walter Bowman had agreed to certify Taylor's work until Taylor's application for license reinstatement was approved. An investigation determined that Mr. Bowman had certified a preliminary permit application which Taylor and unknown others had produced without supervision from Mr. Bowman. The matter was resolved through a Consent Decree in which Mr. Bowman acknowledged that he certified the document in question, and that by so doing, he aided and abetted the unlicensed practice of engineering by Robert Taylor and possibly others, and potentially placed the public health safety and welfare at risk. For this violation, Mr. Bowman agreed to the following sanctions: (1) a \$1000 fine, (2) suspension of his professional engineering license for 30 days, (3) completion of Texas Tech University course in Engineering Ethics within 6 months. The Board approved the Consent Decree on July 20, 2012

KENTUCKIANA ENGINEERING COMPANY

Kentuckiana Engineering Company, a Kentucky Corporation with offices in Louisville, was disciplined for offering engineering services in Kentucky on a lapsed business entity permit, in violation of KRS 322.060. The case was settled by a Consent Decree wherein the firm acknowledged the violation and agreed to pay a \$1000 fine and file for reinstatement of its business entity permit. The Board accepted the Consent Decree on July 20, 2012.

DONALD D. MCGREW, PLS

Mr. Donald D. McGrew, PLS, of Cadiz, was disciplined for incompetence in the practice of land surveying in violation of KRS 322.180 (2) and for violating the surveying Standards of Practice, 201 KAR 18:150 in connection with a retracement survey he performed on a property

in Trigg County in 2011. The case was settled by a Consent Decree wherein Mr. McGrew acknowledged the violations, and agreed to the following sanctions: (1) a Letter of Reprimand (2)

must complete a college level course in boundary surveying. The Board accepted the Consent Decree on July 12, 2012.

# 2012 BOARD OF DIRECTORS

**Randall Russell, PE**  
**Chair**

160 Democrat Drive  
Frankfort, KY 40601  
(502) 695-4357  
[garbargeguru@hotmail.com](mailto:garbargeguru@hotmail.com)

**David Atwell, PE, PLS**  
**Vice Chair**

606 New Street  
Horse Cave, KY 42749  
[retiredatwell@hotmail.com](mailto:retiredatwell@hotmail.com)

**James Sigler, PE**  
**Secretary**

400 E. Vine St. #300  
Lexington, KY 40507  
(859) 233-2100  
[sigler@entran.us](mailto:sigler@entran.us)

**Richard Howerton, PLS**  
**Board Member**

404A Main St.  
Greenup, KY 41144  
(606) 473-5684  
[richard.howerton.sr@howerton-eng.com](mailto:richard.howerton.sr@howerton-eng.com)

**Thomas Lester, PE**  
**Board Member**

College of Engineering, 312  
CRMS Bldg.  
Lexington, KY 40506  
[lester@engr.uky.edu](mailto:lester@engr.uky.edu)

**Neville Pinto, PhD**  
**Board Member**

J.B. Speed School of Engineering,  
University of Louisville  
Louisville, KY 40292  
(502) 852-6281  
[ngpint01@gwise.louisville.edu](mailto:ngpint01@gwise.louisville.edu)

**Ben Quinn, PE, PLS**  
**Board Member**

65 Aberdeen Dr.  
Glasgow, KY 42141  
(270) 651-7220  
[bquinn@aei.cc](mailto:bquinn@aei.cc)

**James Riney, PE, PS**  
**Board Member**

416 W. Third St.  
Owensboro, KY 42301  
(270) 929-5685  
[jriney@bellsouth.net](mailto:jriney@bellsouth.net)

**Mike Ritchie, PE, PLS**  
**Board Member**

523 Wellington Way  
Lexington KY 40503  
(859) 321-3804  
[mritchie@photoscience.com](mailto:mritchie@photoscience.com)

**Beverly Smith,**  
**Board Member**

1600 Man O' War Blvd.  
Lexington, KY 40513  
[beverly.smith@insightbb.com](mailto:beverly.smith@insightbb.com)

**Sam Williams, PE, PLS**  
**Board Member**

1555 Old Frankfort Pike  
Lexington, KY 40504  
(859) 425-2810  
[swilliam@lexingtonky.gov](mailto:swilliam@lexingtonky.gov)

# 2012 CALENDAR OF EVENTS

August 22-25  
October 5  
October 26  
October 27

NCEES Annual Meeting  
Board Meeting  
PE, PS Exams  
FE, FS Exams

St. Louis MO  
Frankfort KY  
TBD  
TBD



(800) 251-1280

www.hayesinstrument.com

**HAYES**  
INSTRUMENT CO.

**ES**

**REFLECTORLESS TOTAL STATION**

- ▶ 36 HR BATTERY LIFE
- ▶ TS SHIELD ADVANCED SECURITY & MAINTENANCE
- ▶ FAST & POWERFUL EDM  
500M NON-PRISM (1,640FT) | 4000 PRISM (13,120FT)
- ▶ EXCLUSIVE LONGLINK COMMUNICATIONS 300M (384FT)



TSshield™ is an advanced telematics-based communications module designed to protect the owner's investment. TSshield enables owners to receive on-instrument notices of available firmware updates. Additionally, if the instrument is lost or stolen, a future firmware release will allow the owner to send a coded signal virtually anywhere in the world to the instrument to disable it.



**THE UN-CONVENTIONAL TOTAL STATION**

**OS**

- ▶ MAGNET FIELD ON-BOARD
- ▶ 20 HR BATTERY LIFE
- ▶ ADVANCED ANGLE-ACCURACY
- ▶ FULL TOUCH SCREEN WITH LARGE GRAPHICS



**MAGNET™**

MAGNET Enterprise is a web-based solution to manage your field and office data in the cloud. Track your assets and communicate with all those involved on projects. Log in from any browser for live updates. Save time and money.



**(800) 251-1280**

www.hayesinstrument.com

Saturday, April 14, 2012 10:00am

Kentucky Engineering Center - 160 Democrat Drive - Frankfort, KY 40601

**BOARD OF DIRECTORS**

**CALL TO ORDER**

Don Pedigo, KAPS 2012 President, called the April 14, 2012 KAPS Board of Directors Meeting to order.

**PROXY VOTES**

Two proxys were reported under deadline: David Dummer assigned his proxy to Bob Fentress on March 27, 2012; Doug Comer assigned his proxy to Bill Jones on March 31, 2012. Dempsey Miracle moved to accept these proxys. Brian Cox seconded. Motion carried.

**MEMBERS PRESENT**

Don Pedigo – 2012 KAPS President; Thomas Clayborn – President Elect; James Mayo – Vice President of External Affairs; John Schneider – Vice President of Internal Affairs; Brian Cox – Past President; Bill Jones – Secretary/Director; Chris Gephart – Kentucky Board of Licensure Liaison; Ted Niemann – GIAC Liaison; Tom Bushelman – Director; Bob Fentress – Director; Michael Ladnier – Audubon Chapter Chair; Shaun Foley – Barren River Chapter Chair; Kevin Phillips – Bluegrass Capital Chapter Chair; Tim Ryan – Northern Kentucky Chapter Chair; Jonathan Payne – Jackson Purchase Chapter Chair; Dempsey Miracle – Southeast Chapter Chair

**STAFF PRESENT**

Molly Forrest – Administrative Assistant

**MEMBERS ABSENT**

David Dummer – Treasurer/Director; Craig Palmer – NSPS Governor; Bob Westermeyer – KSPE Liaison; Steve Lilly – KAMP Liaison; Thad

Lucas – Director; Doug Comer – Director; Tim Chilton – Falls of the Ohio Chapter Chair; Robert Miller – Green River Chapter Chair; Johnny Justice – Highlands Chapter Chair; Mike Ruggles – Northeast Chapter Chair

**GUESTS PRESENT**

Richard Montgomery – County Surveyor Committee Chair; Nick Jerdon – Bluegrass-Capital Chapter

**PRESIDENTS WELCOME**

President Don Pedigo welcomed everyone to the meeting and proceeded with introductions.

**ADDITIONS OR REVISIONS TO THE AGENDA**

There were no additions or revisions to the agenda.

**REVIEW AND APPROVAL OF BOARD MEETING MINUTES**

The minutes of the February 22, 2012 Board Meeting were reviewed. John Schneider made a motion to accept the minutes. Tom Clayborn seconded. Motion carried.

The minutes of the February 23, 2012 Board Meeting were reviewed. Bob Fentress made a motion to accept the minutes. James Mayo seconded. Motion carried.

The minutes of the February 24, 2012 General Membership Meeting were provided for review. Approval will take place at the February 2013 Annual Conference.

Chris Gephart raised the question as to whether KAPS had to wait until the 2012 General Membership Meeting minutes were approved at



the 2013 Annual Conference before implementing electronic voting for KAPS officers. The consensus was to move ahead with electronic voting prior to approval of said minutes.

#### KAPS OFFICER REPORTS

**President's Report** – President Pedigo asked everyone to read over his report but elaborated on KAPS and TAPS coming together to financially support injured surveyor, Jeff Travis and the success of the KET Telefund.

**President Elect's Report** – written report submitted

**Treasurer's Report** – written report submitted. Bob Fentress made a motion that the \$1,048.89 in Account 1180 (surrendered from the closed KAPS South Central Chapter) be transferred to the regular scholarship fund. Dempsey Miracle seconded. Chris Gephart wondered if the money should be absorbed by the adjoining Chapters: Southeast and Green River. Richard Montgomery suggested redrawing the boundary lines giving part to the Southeast Chapter and the remainder to the Green River Chapter. However, Mr. Montgomery assured the board the Green River Chapter would have no problem with the money going to the scholarship fund. Motion carried. President Pedigo tabled the redistricting issue to give adequate time to look at the current layout and to give the idea more thought.

Jon Payne made a motion to accept the Treasurer's Report. Tom Clayborn seconded. Motion carried.

**Administrative Assistant's Report** – Molly Forrest referred to the written report emphasizing the upcoming launch of the new website as well as the Annual Golf Outing and Picnic. She encouraged everyone to submit any ideas for the 2012 Fall Seminars and/or the 2013 Annual Conference. Proceeds from the 2011 Fall Seminars as well as Chapter portions of the membership dues will be on their way to the Chapters soon.

#### OLD BUSINESS

**KAPS Website** – President Pedigo asked the board to review the new website and submit comments or suggestions to Molly and she will pass those on to Andrew Dodson of Code Forte. The final invoice will be paid to Andrew right away.

Tom Clayborn shared how to get connected on the KAPS Facebook page. Chris Gephart emphasized the importance of Facebook in connecting with the next generation of surveyors. **Plat Law Legislation** – Bob Fentress stated the comments received from the board indicated the group didn't seem ready to move forward on the legislation. Bob was recently informed that legislation on this issue was filed in 1990. The legislation was partially successful at that time. He would like time to review the 1990 legislation with Government Strategies prior to bringing the issue back before the KAPS Board.

**Statute of Limitations Legislation** – Bob Fentress reported the bill did not have any opposition but the legislation got caught up in a conflict between two legislators about an unrelated bill. The plan is to meet with Government Strategies regarding the legislation; however, the same Statute of Limitations bill will most likely be presented again during the next legislative session. Sponsorship may change but the bill will probably stay the same.

**Mr. Paul Primavera for Life Membership Request** – President Pedigo explained that Mr. Primavera has been a member for over ten years and does meet the criteria of the By-laws. Tom Bushelman, By-Laws Committee Chair, concurred. Two-thirds of the board must approve Life Membership status.

Chris Gephart made a motion to table this matter (item 6d on the Agenda) until the next item on the agenda (6e – Membership Clarifications) has been clarified and/or agreed on. Brian Cox seconded.

President Pedigo has not sent a letter to Mr. Primavera informing him his request was still under review. Ted Niemann stated his opinion was to bring Mr. Primavera's request before

a vote before Membership Clarification (6e) since his request came in prior to the board seeing that membership clarification needed to be addressed. Mr. Gephart interjected that his motion is based on needing education regarding current membership clarification before voting on Mr. Primavera's request—not to necessarily change the "rules" before voting on Mr. Primavera. Dempsey Miracle challenged the board to look at the request from the viewpoint of this retired surveyor wanting to honor KAPS by staying connected to the association.

The vote to table the issue failed.

Bob Fentress made a motion to accept Mr. Primavera as a Life Member. Jon Payne seconded. With only two (2) "nay" votes, the motion passed with two-thirds (2/3) majority vote.

**Membership Clarifications - Article III Section 2(b), Article IV Section 1(b)** – Bob Fentress moved to have the By-laws Chair to come back to the board with a brief clarification of the classifications and any recommendation he might have for changing the classifications based on the discussion he's heard at this meeting. Dempsey Miracle amended the motion to charge all board members to review the By-laws themselves and come back to the board with their own recommendations. Mr. Fentress accepted the amendment. Mr. Miracle seconded. Motion carried.

#### NEW BUSINESS

**Next KAPS Board Meeting** – The next KAPS Board Meeting will be held Friday, June 22, 2012, 6:00 P.M. EST at the Wickland Historic Mansion, 550 Bloomfield Road (US 62) in Bardstown, KY 40004.

**Corporate Membership** – President Pedigo mentioned there have been questions as to whether all employees of a corporation could be included under a Corporate Membership or if those employees must carry their own individual KAPS membership. Bob Fentress stated he thought this would fall under the membership clarification issues brought up

previously in the meeting. Tom Bushelman, By-laws Chair, informed the board the By-laws do not currently state that individuals are covered under Corporate Membership. President Pedigo ended discussion on the issue at this meeting, leaving it under the membership clarification to be discussed at a later date.

**Office Space Available** – President Pedigo reported the availability of double the office space next to the current KAPS office at 124 Walnut Street, Frankfort, KY. The current space is crowded and getting more so all the time. If KAPS decided to employ an Executive Director or any other employee(s) in the future, the present office would not be adequate. Currently, the rent is \$435/month. The rent on the space next to it would be double the rent within four (4) years. The landlord is offering a discounted rate of \$800 to begin, with an increase of \$25 per year through the fourth (4<sup>th</sup>) year. The address would not change as the landlord plans to simply switch out the doors of the spaces. The issue was discussed extensively including the option of sharing the larger space with another organization, the possibility of scanning and storing documents electronically, and the overall need. Tom Clayborn made a motion to rent the office space next door. Tom Bushelman seconded. Motion carried.

**Molly Forrest One (1) Year Evaluation** – Chris Gephart made a motion to increase Molly Forrest's salary to eighteen dollars (\$18) an hour and add five (5) personal days to her current package. Brian Cox seconded the motion. Motion carried.

#### EX-OFFICIO DIRECTORS REPORTS

**KAMP Liaison** – no report. President Pedigo reminded everyone of the GIS Conference scheduled for September 26-28, 2012 at the Louisville Marriott Downtown.

**KY State Board of Licensure Liaison** – a written report was submitted. Chris Gephart emphasized impending fund transfers from the Governor's Office will eventually have an impact on operations.

Mr. Gephart also reported a change regarding NCEES computer based testing beginning in January 2014. The FS and FE exams will be offered four times per year in Lexington, Louisville and Cincinnati. Fees will be increased and there will be obstacles with some states statutes and regulations requiring an 8 hour written examination as a licensing requirement. Other issues to overcome will be the number of reference materials allowed and how to deal with state-specific portions of the PS exam.

The MathCounts program was also mentioned. Although 72 scholarships were awarded in the program and several schools provide specialized training for the event, the top candidates rarely attend Kentucky universities. The State Board of Licensure discussed ways to entice the “second tier” award winners to attend college and practice engineering in Kentucky.

Professional Development Chair – President Pedigo directed everyone’s attention to the 2011 Fall Seminar Report included in the board packet. The net profit was \$19,801.83. Funds will be distributed according to the board approved formula (details included in the board packet). Bob Fentress made a motion to approve the disbursement to the Chapters. Dempsey Miracle seconded. Kevin Phillips asked if the projector rental owed to the Bluegrass-Capital Chapter had been figured into the net profit amount. Since no invoice had been received, it had not been deducted from the net profit and was not included in the figures before the board at this meeting. Mr. Fentress amended his motion to include the rental fee into the calculation and then disbursement be made to the Chapters. Mr. Miracle agreed. Motion carried.

President Pedigo asked the board to let him know which Chapters would like to have a fall seminar.

The Board of Licensure requires seminar submission 60 days prior to the seminar date for pre-approval.

CHAPTER REPORTS

Audubon – written report submitted

Bluegrass-Capital – written report submitted

Falls of the Ohio – no written report. Bill Jones reported good attendance at the last meeting.

Green River – no written report. Richard Montgomery reported a meeting in March to specifically to publish the Chapters comments regarding the easement issue. The April meeting has been rescheduled for May 8 in Columbia, Kentucky.

Northern Kentucky – no written report. Tim Ryan reported past KAPS President, Bud Payne, wanted everyone to know of 14 Boy Scouts, fifty percent (50%) passed and got their surveying merit badge.

Purchase – written report submitted. Jon Payne reported their Chapter is planning to have a fall seminar; subject to be determined.

Southeast – written report submitted. Dempsey Miracle elaborated on their discussion regarding submitting plats electronically.

COMMITTEE REPORTS

Annual Conference – President Pedigo directed everyone’s attention to the 2012 Conference report in the board packet. He expressed his pleasure with the success of the conference. Net profit was \$23,620.58 not including any projector fees that may not be included. Two hundred fifty-seven (257) were registered with one hundred fifty eight (158) being KAPS members.

President Pedigo reported a group recently visited seven (7) hotel facilities in Louisville to find a host hotel for the 2013 Conference. The choice has been narrowed down to three facilities. The Marriott has submitted a two-year deal for 2013 and 2014. A three-year deal may be a possibility. A decision will be made shortly.

Annual Picnic – President Pedigo encouraged everyone to attend the picnic and golf outing on June 22 and 23 in Bardstown. He also asked everyone to promote these events within their chapter. Richard Montgomery thanked everyone for their support in getting the County Surveyors bill passed. He also announced the legislators that helped get the bill passed will be invited to the picnic. He encouraged the board to build relationships with their legislators. The board showed their appreciation to Mr. Montgomery for all his work on the bill. The ceremonial bill signing will April 17, 3:30 P.M. EST in the Governor’s Office.

Boy Scouts – the discussion regarding the consideration of the Boy Scouts being a chapter level project as opposed to a state level project was tabled at the last meeting. Since key members were not present to discuss the matter, President Pedigo tabled the discussion until the next meeting.

By-Laws – no written report submitted. Tom Bushelman called the By-laws a “dynamic document.”

County Surveyors – no written report submitted. President Pedigo reminded everyone of Richard Montgomery’s earlier announcement regarding the County Surveyors bill. Tom Bushelman interjected that Boone County may be considering giving him, as the County Surveyor, an office in the court house.

Legislative – written report submitted

Professional Development – no further report

Public Relations – written report submitted. Tom Clayborn further encouraged the chapters to do some charity work in their areas to promote KAPS throughout the state. Take pictures and give reports to be shared in The Interior Angle and on the website.

SPECIAL COMMITTEE REPORT

Timber Theft and Trespass Reduction Task Force – President Pedigo reported the Senate did not move on the issue.

Easement Regulation – President Pedigo is to get committee names to Bob Fentress soon.

ADJOURNMENT

Brian Cox made a motion to adjourn. Dempsey Miracle seconded. Motion carried. Meeting adjourned.

Respectfully submitted by

Molly M. Forrest for Bill Jones, PLS, Secretary

Edited for content by Doug Comer, Editor.

## **201 KAR 18:192. Continuing professional development for professional land surveyors.**

RELATES TO: KRS 322.290(15)

STATUTORY AUTHORITY: KRS 322.290(4), (15)

NECESSITY, FUNCTION, AND CONFORMITY: KRS 322.290(15) requires the board to adopt a program of continuing education for professional land surveyors. This administrative regulation implements the continuing professional development program mandated by KRS 322.290(15) for professional land surveyors.

### **Section 1. Definitions.**

(1) "Completion" means the professional land surveyor has satisfactorily met specific requirements of an offering by taking and passing a university course or attending a seminar.

(2) "Continuing professional development" or "CPD" means participation in activities, beyond the basic educational requirements, that:

(a) Provide specific content planned and evaluated to improve the land surveyor's professional competence;

(b) Encourage acquisition of new skills and knowledge required to maintain competence;

(c) Strengthen the professional land surveyor's critical inquiry and balanced judgment;

(d) Raise the ethical standards within the professional community; and

(e) Which meet the requirements established by the provisions of this administrative regulation.

(3) "CPDC" means the Continuing Professional Development Committee.

(4) "Professional development hour" or "PDH" means not less than fifty (50) minutes of instruction or presentation that meets the requirements of this administrative regulation.

(5) "Provider" means a person, school, association, company, corporation, or group who has developed a CPD activity and participates directly in the presentation.

(6) "Sponsor" means a group, organization, or professional society, offering activities by providers.

### **Section 2. Continuing Professional Development Committee.**

(1) The chair of the State Board of Licensure for Professional Engineers and Land Surveyors shall appoint a Continuing Professional Development Committee and name its chair.

(2) The CPDC shall consist of three (3) board of licensure members of which at least two (2) are professional land surveyors.

(3) Work of the CPDC shall be considered work of the board and compensation shall be given as provided by KRS 322.270.

(4) The CPDC shall hold regular meetings and a record of its action shall be maintained.

(5) The CPDC shall have the authority to rule on all matters concerning continuing professional development for professional land surveyors. Decisions of the CPDC shall be ratified by the board. A licensee who disagrees with a decision of the CPDC may direct his or her concerns to the board for consideration at **a subsequent meeting of the board** [~~the board's next meeting~~].

### **Section 3. Program Structure.**

(1) Except as provided otherwise in this administrative regulation, a professional land surveyor shall complete and report to the board a minimum of eight (8) professional development hours for each calendar year, for a total of a minimum of sixteen (16) professional development hours for each reporting period.

(2) The requirement for professional development hours shall include a four (4) hour board sponsored course in standards of practice for professional land surveyors, professional ethics, and the code of professional practice and conduct, taken once every four (4) years. In the year that this course is taken, it shall count as four (4) of the required eight (8) hours.

(3) A maximum of four (4) hours in excess of the **sixteen (16)** ~~eight (8)~~ professional development hours required to be earned in a **reporting period** ~~calendar year~~ may be carried forward to the next **reporting period** ~~calendar year~~.

(4) Failure to earn the **sixteen (16)** ~~eight (8)~~ professional development hours **per reporting period** shall make the licensee ineligible for licensure renewal.

### **Section 4. Criteria for Professional Development.**

(1) Professional development hours may be earned by successful completion of the following activities subject to approval by the CPDC and board:

(a) College or university courses;

(b) Seminars;

(c) Tutorials;

(d) In-house programs sponsored by corporations or other organizations;

(e) Correspondence courses;

(f) Televised or videotaped courses [~~with approved supervision~~];

(g) Distance learning courses [~~with approved supervision~~];

(h) Teaching or instructing courses, programs, or items specified in this subsection; this [~~The~~] credit may be claimed at twice the



number of hours permitted participants, **but such credit may not be claimed more than once for teaching or instructing the same or substantially similar course, program, or item;**

(i) Making or attending approved presentations at technical or professional meetings; or

(j) Publication of papers, articles, or books related to the practice of land surveying.

(2) Activities described in subsection (1) of this section shall:

(a) Be relevant to the practice of land surveying;

(b) Contain technical, ethical, or managerial subjects;

(c) Be an organized program of learning, [presented sequentially];

(d) Be conducted by individuals with education, training, or expertise [acceptable to the CPDC];

(e) Be offered for the number of professional development hours **recommended by the program author, subject however, to review, and acceptance or adjustment,** [approved] by the CPDC; and

(f) Not include in-service training, orientation to specific institutional policies and practices, or time used to sell or advertise a product.

(3) CPD activities shall earn credit only when substantially different from a course for which credit was **claimed or granted** in the **current calendar year or** previous two (2) calendar years.

(4) Professional development hours shall be converted as follows:

(a) One (1) university semester hour shall equal fifteen (15) professional development hours.

(b) One (1) university quarter hour shall equal ten (10) professional development hours.

(c) One (1) continuing education unit shall equal ten (10) professional development hours.

~~[(5) Unless stated otherwise in this administrative regulation, credit for courses shall be earned at the rate of one (1) professional development hour for each hour of instruction completed, if approved by the CPDC.]~~

**Section 5. Approval of a Continuing Professional Development Activity.** Activity approvals may be granted for sponsors, providers, or individual professional land surveyors as follows:

(1) Approval of activities is valid for a specified approval period or until alteration of the activity is approved by the CPDC.

(2) Failure to notify the CPDC of a change in an activity, **including a change in the instructor,** may render approval of the activity null and void.

(3) Prior to approval, an activity shall not be advertised as approved for Kentucky professional land surveyors **but may be advertised** [without a conspicuous notice] that the activity has been "submitted for consideration."

(4) If prior **or post** approval is desired, a written request for approval of the activity shall be submitted to **and received by** the CPDC on the "Continuing Professional Development Course Approval Form" at least **forty five (45)** [sixty (60)] days prior to **the meeting date of the CPDC at which the request will be considered** [presentation of the activity. All other requests for approval of an activity shall be submitted to the CPDC on a "Continuing Professional Development Course Approval Form" at least two (2) weeks before the CPDC meeting which considers the activity for approval].

(5) All requests for approval of an activity shall be accompanied by:

(a) A detailed outline and objectives;

(b) A time outline including registration, introductions, welcomes, breaks, and meals;

(c) Handouts or reference materials needed to evaluate the activity; and

(d) A resume for each instructor or speaker in the activity.

(6) The CPDC or board reserves the right to send a representative to monitor an activity:

(a) The provider or sponsor shall waive all fees for the CPDC or board representative; and

(b) Approval for the activity may be withdrawn for subsequent iterations of the activity, if significant variation is observed from the approved activity.

(7) An evaluation form shall be made available for participants at each presentation.

(8) An individual under disciplinary action from the board or a business entity with a principal who is under disciplinary action from the board shall be prohibited from presenting a CPD activity for credit without **prior, written** [specific] approval from the board.

(9) When a provider fails to obtain prior approval, a professional land surveyor may request credit for an activity by making a written request **for approval** to the CPDC and including **in that request,** the items listed in subsection (5) of this section.

(10) Upon approval, an activity shall receive a CPD number which shall be used to identify the activity.

(11) If an activity is not approved by the CPDC, the requestor shall be sent notice of nonapproval within two (2) weeks of its decision. This decision shall be presented to the board at its next meeting for ratification.

**Section 6. Exemptions and Extensions.** The following professional land surveyors may be exempted from the requirements of this

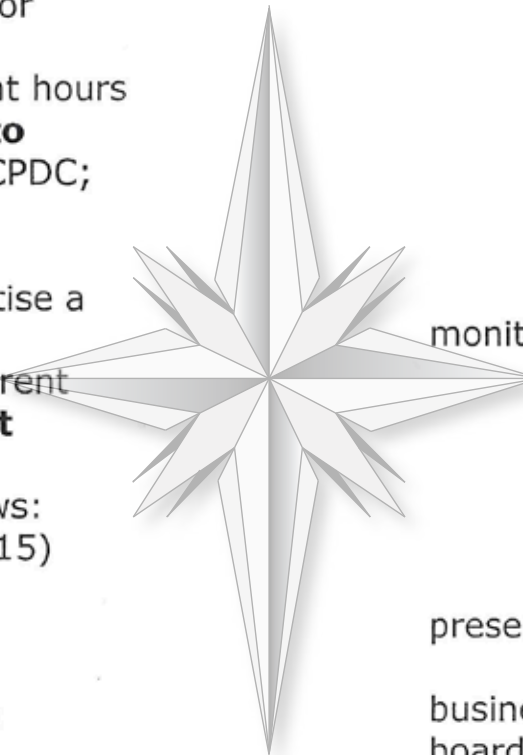

administrative regulation by submitting a written request to the CPDC with supporting documentation for the exemption:

**(1)** A professional land surveyor shall be exempted for the **reporting period containing the** calendar year in which he or she is initially licensed by the board.

**(2)** A professional land surveyor who cannot satisfy the CPD requirement because of physical disability, illness, or other extenuating circumstance may be exempted for the calendar year in which the disability, illness, or extenuating circumstance occurs. The CPDC may grant an extension of time to fulfill the yearly CPD requirement for an extenuating circumstance.

**(3)** An exemption or extension request shall be made in writing for each calendar year and the exemption or extension is only valid for that calendar year.

**Section 7. Reinstatement.** Before a license is reinstated by the board, a former professional land surveyor shall earn the continuing professional development hours required for each year the license was revoked, suspended, or expired, up to a maximum of thirty-two (32) professional development hours.

#### **Section 8. Reporting.**

**(1)** On the biennial renewal form, a professional land surveyor shall certify whether or not **he or she has complied with** the requirements of this administrative regulation [~~have been met~~].

**(2)** Biennial renewal forms received after September 1 shall be subject to the audit process in Section 9 of this administrative regulation.

#### **Section 9. Audits.**

**(1)** Compliance with the annual CPD requirements shall be determined through an audit process.

**(2)** Professional land surveyors shall be audited through a random selection process or as the result of information provided to the board.

**(3)** Individuals selected for audit shall **within thirty (30) days of the board's request** provide the board with documentation of the CPD activities claimed for the renewal period. Appropriate documentation shall include:

**(a)** Verification records in the form of transcripts, completion certificates, or other documents supporting evidence of participation.

**(b)** Information regarding seminar or course content, instructors, and sponsoring organizations.

**(4)** Verification records and documentation for audit purposes shall be maintained by individual licensees for a period of **the current reporting**

**period and the two previous reporting periods** [~~three (3) years after completion of the CPD activity~~].

**(5)** If continuing professional development credit is disallowed, a professional land surveyor shall have 180 calendar days after notification to substantiate the original claim or earn other credit to meet the requirement.

**(6)** [~~(4)~~]-Failure to comply with the CPD requirements shall be considered a violation of KRS 322.180(3) subjecting the professional land surveyor to disciplinary action.

**(7)** [~~(5)~~] An audit resulting in a determination of noncompliance shall subject the professional land surveyor to an automatic audit the next reporting period and each subsequent reporting period until **an** [a] audit results in a determination of compliance.

**(8)** [~~(6)~~] A professional land surveyor who is under investigation pursuant to KRS 322.190 may be subjected to the audit requirements of this section.

#### **Section 10. Incorporation by Reference.**

**(1)** "Continuing Professional Development Course Approval Form", November 1999, State Board of Licensure for Professional Engineers and Land Surveyors is incorporated by reference.

**(2)** This material may be inspected, copied, or obtained, subject to applicable copyright law, at Kentucky State Board of Licensure for Professional Engineers and Land Surveyors, 160 Democrat Drive, Frankfort, Kentucky 40601, Monday through Friday, 8 a.m. to 4:30 p.m. (26 Ky.R. 1460; Am. 1678; eff. 2-24-2000; 33 Ky.R. 856; 1284; eff. 12-1-06; 38 Ky.R. 654; 894; eff. 12-2-11.)

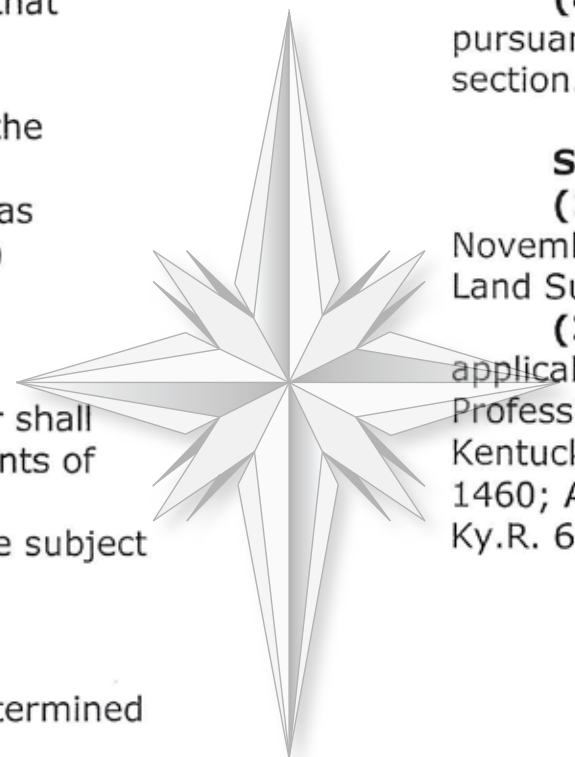

## Andrew C. Kellie, PLS

Department of Industrial & Engineering Technology  
Murray State University, Murray KY 42071, [akellie@murraystate.edu](mailto:akellie@murraystate.edu)

# RIGHT FROM THE BEGINNING

When I walked into the office and turned on the lights on Monday morning, I felt as if I had never left. Sunday had been filled first with church and then with soccer games for both girls and boys. That was pretty much usual. Saturday had been devoted to continuing education. Saturdays spent at seminars always seemed like an extension of the regular work week. The difference was that you paid to attend instead of being paid for surveying. Before going, I went through the usual soul searching. Wasn't I working with cutting edge technology every day? Why did I need to get up at 5 AM and drive across three counties to listen to some egghead talk about what I did every day?

In the end, I caved. The continuing education program was being sponsored by my chapter, there would be a lot of surveyors I knew at the meeting, and I'd be conspicuous by my absence. Despite my initial reluctance, the day was actually pretty good. The official program dealt with the theory of the finer points of deeds, plats, and wills. It was conducted by a renowned speaker. The unofficial program dealt with the application of the finer points of deeds, wills, and codicils to actual survey practice. It was conducted by the surveyors who somehow managed to relate the seemingly abstract points to various jobs, in various locations, at various times sometime within recorded history. At the finish, a good time was had by all, my continuing education requirement was up-to-date, and I wouldn't have to worry again about intellectual advancement until next year.

It being Monday morning, I naturally had to get my crews into the field. Sam and Tom were assigned to a retracement on the Tucker farm. The job was an estate survey, and the farm was scheduled to go under the hammer at the end of the month. The attorney handling the estate

had signed and returned our contract. He sent with it a copy of the deed to the Tuckers and a plat to the property. The deed, drawn in 1982, was unremarkable. It described the property as a quarter section (160 acres) and gave the township and range. At first appearance, the plat, drawn in 1942, was intriguing. It was drawn in pencil on the back side of a piece of wall paper—nice pattern, although a bit dated—and signed by “J.R. Smith, Surv.” The plat showed the bearings to the nearest ¼ degree and distances to the nearest foot. I suspected a compass and chain survey. Monuments—invariably trees and “pointers” of every species native to the south—were called at each corner, but no adjoining were shown. A “half” north arrow suggested use of magnetic orientation. The title on the plat described it as having been done for one of the Tucker's predecessors it title. Based on my continuing education program, I wondered if the plat qualified as an “ancient map”.

Naturally, there was a problem. The 1982 deed called for the entire section; the 1942 plat did not. According to the family, the deed was right, the tract was “square” and the entire ¼ section belonged to them. The northwest, southwest, and southeast quarter quarters were in row crops; the northeast quarter quarter was (or had been) the farmstead and the farm woodlot. According the plat, there seemed to be an outsale at the northeast corner. This made the shape of the parcel shown on the plat look like a reduced version of the State of Utah. Still, the plat had been done for a predecessor in title. Why did “J.R. Smith, Surv.”, who was so careful about the monuments at each corner, show an apparent outsale? But, it was still early innings, and there was much to be learned.

Since I'm the surveyor, I told Samantha to begin the perimeter survey along the lines she and I

had walked late last week and to try to locate the monuments shown by “J.R. Smith, Surv.” that hadn't been hit by lightning, killed by pine beetles, eaten by the borers, or destroyed by the latest human-caused environmental catastrophe. There was a whole list of matters I needed to check at the courthouse. I mentally added the Tucker Farm to the list. Right from the beginning, there are some jobs that you know will be difficult, and the Tucker Farm was shaping that way.

Tim was assigned to a boundary retracement on the Weatherbee Tract. His work was for a client of long standing who eventually would be subdividing the land. The deed to the client's grantor was dated 1977 and included a detailed metes and bounds description. Bearings were given to the nearest second and distances were shown to the nearest hundredth of a foot. Other than calling for a laundry list of bearings and distances on the north line, the description was otherwise unremarkable.

A plat showing the land conveyed, of even date with the deed, had been reduced and was included with the deed description. At first appearance, it was a sharp contrast to the pencil-on-wallpaper offering of “J.R. Smith, Surv.” The line work was crisp and sharp and must originally have been done in ink. “Leroy” lettering had been used. There was a fancy north arrow with the declination noted, and the names of the adjoining were displayed, together with a deed reference. Monuments were shown on the plat at some of the corners, although mostly on the eastern side of the tract. The north line on the plat was just as jagged as it had read in the description. There was even a location map in the upper left corner of the drawing. A note on the map explained that the parcel was the result of combining two tracts of land and gave the book and page number of each. Cartographically, the map was a handsome piece of work.

Since I'm the surveyor, I reviewed the job with Tim. He had been working there since last Thursday. He had located everything that looked like a corner and was now at the point where he could probably close a rapid static loop by evening. The job looked like it was coming

together. Right from the beginning, there are some jobs that you know will fall right into place, and the Weatherbee Tract was shaping that way. It was late morning before I got to the courthouse. I began on the Tucker farm first. One of the topics we had discussed during the continuing education program involved determinable fees. What if, I reasoned, one of Tucker's predecessors in title had granted a part of the northeast quarter to someone for a specific purpose with a reversionary interest in the grantor? I traced the Tucker tract back through several predecessors. For each predecessor, I checked the grantor index for an outsale of land at the northeast corner. To my surprise, I found just such a grant, made in 1880, deeding a tract of land “as marked at the northeast corner of the grantor herein” to be the land of the grantee “for so long as the land so described and the buildings thereon be used for a place of worship”. The grantee was the New Hope Church.

Our public library is right next to the courthouse. It was my next stop. There is a set of Sanborn maps there that cover the part of the county where the Tucker farm is located. Sure enough, a map done in 1893 showed a church building on a lot at the northeast corner of Tucker, clearly labeled “New Hope Church”. Posted on the wall in the library is a 15 minute topographic quad of our county. According to the legend, it was prepared “by plane table methods” in 1918. A building symbol—complete with cross—was located at the northeast corner of Tucker.

The deed to the church was drawn in 1880. One map showed the building there in 1893, another map showed it in 1918, and in 1942 “J.R. Smith, Surv.” had shown Tucker's property as not including the church lot at the northeast corner. By 1982, the church was gone, the land was in timber, and the Tucker family assumed that they were in possession of the entire quarter. The deed had limited the grant “for so long as the land...be used for a place of worship”. That use apparently had ceased. Or had it?

Since I'm a surveyor, I have observed a very close connection between the location of a church and the proximity of a cemetery.

Originally, it must have been a practical matter. When the church was built—sometime between 1880 and 1893—there was no way to put the departed into a Cadillac hearse for a drive to a cemetery on the other side of the county. I got on the cell phone to Sam in a big hurry and told her to be sure to look for a graveyard. I was too late. She had already found it. She said for me to relax because it wasn't going anywhere.

Samantha also had matched almost all of the corners we had located during our reconnaissance to corners shown by "J.R. Smith, Surv." Where a corner was missing, there was usually a surviving pointer. Sam said she had gotten pretty good identifying trees. She now was on her way back to the office to input their data. Frankly, there are some surveys where I feel pretty useless!

When I got back to the courthouse, I did some more work on the deeds to the Weatherbee land. Before beginning the survey, I got deeds to all of the adjoining and the current Weatherbee deed. However, I still needed to grantor-out the Weatherbee parcel and check previous descriptions for errors and omissions. The current Weatherbee deed had been drawn in 2005. The deed description was the same as in deeds to predecessors in title dated 1992 and 1987. In 1977 two tracts had been joined to form the Weatherbee tract we were retracing. When I finally found those deeds, it was pretty late. I ran copies of both of the deeds for the tracts which had been joined and dropped them in my briefcase. Usually, I write out the deed long hand so I can get the shape of the parcel in my head, but I was getting those it's-time-for-us-to-go-home looks from the courthouse staff, and I decided not to overstay my welcome.

The next morning, Tim and I downloaded his data. He had located lots of points. A few were obviously corners; others were obviously points. All were difficult to evaluate because at numerous corners on the map no monumentation was shown. The deed was no more helpful. It often referred to lines "running thence to a point." The scrivener must have used the term "point" in the mathematical sense—there isn't a ridge in our

entire county.

Since I'm the surveyor, I was expected to figure it out. It required two pots of coffee. Mysterious rotations kept appearing in our lines; if we held the bearing on the west line, the east line was totally unreasonable. If we used the south line, nothing seemed to check. If orientation weren't enough of a problem, our work showed a decided kink in the north line. The 1977 plat furnished us showed the north line to be jagged. We went one better; our north line was both jagged and broken.

As I tried to figure out what was going on, I reflected on a comment from our workshop. The instructor had stressed that if a plat were mentioned in a deed the plat became part of the deed. And this meant everything on the plat. Why had the person who drafted the 1977 plat shown a true north arrow and the magnetic declination? Was this a cartographic flourish, or was the drafter trying to tell me something more? I read the copies of the deeds I had obtained so hurriedly the night before. The description of the west tract was unremarkable. The description of the east tract was unremarkable as well—until I got to the very last sentence in the description. It stated that "the bearings shown herein are based on true north as determined by solar observation made May 16, 1947". We were working with a cartographic masterpiece that showed magnetic bearings on the west side of the tract and true bearings on the east! I also noted that the cartographic masterpiece included no claim of having been based on survey. Reading the source deeds against the plat showed that the bearings on the plat matched exactly the bearings on the two deeds—despite the difference in orientation!

It took the rest of the day, but we finally got it right. At the finish, we had a consistent orientation and shape for the Weatherbee tract, and a plat and description based on a field survey. When our client wished to subdivide the property, everything was in place to do so. I felt pretty good about the two surveys we had just completed. I actually had used the material we had discussed at the seminar. I have to admit

that when I looked at those plats on Monday morning I wasn't just focusing on bearings and distances. I had found the "pointers" on the Smith plat and the orientation symbol on the Weatherbee plat and both were important to our later retracement efforts. Despite—or perhaps because of—the investment of my Saturday there was, at least, a connection to my everyday work.

The experience also reminded me not to be too quick to judge things based on first appearance. "J.R. Smith, Surv." had done an admirable job despite the rustic manner in which he recorded the results of his work. Initially, I had felt pretty

hard toward the drafter of the Weatherbee plat. Thinking it over, though, I did have to admit that were it not for the orientation symbol, we would have struggled longer on that survey than we did.

Finally, I was thoroughly glad to be vindicated. When we started the work, I observed that, "Right from the beginning, there are some jobs that you know will be difficult, and some jobs you know will fall right into place." I was totally correct. The only thing I still need to do is to figure out which is which! But we are improving, and as I have remarked many times before, "This is surveying, and it just doesn't get any better than this!"

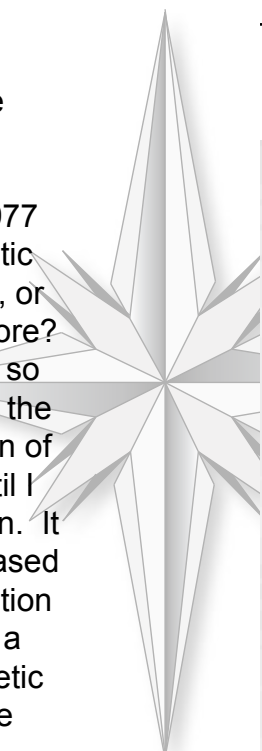

*With best wishes to Richard Montgomery -*

*Steven L. Beshear*



STEVEN L. BESHEAR  
GOVERNOR

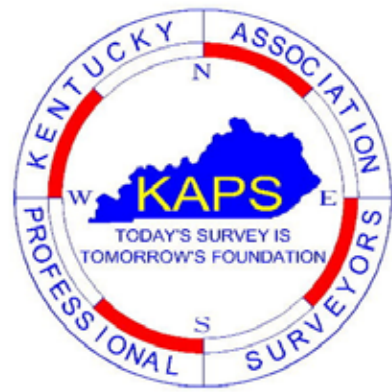

# KAPS 2012 FALL SEMINAR SCHEDULE

Kentucky Association of Professional Surveyors

124 Walnut Street ▪ Frankfort, Kentucky 40601 ▪ Phone: 800.866.3029 ▪ Fax: 502.695.2667 ▪ Email: [mforrest@kaps1.com](mailto:mforrest@kaps1.com)

**ONLINE REGISTRATION IS NOW AVAILABLE AT [WWW.KAPS1.COM](http://WWW.KAPS1.COM)**

**\*Refunds: A full refund will be granted for cancellations at least 15 days prior to the seminar.**

**A \$25 penalty will be assessed for cancellations made less than 15 days prior (as determined by postmark). All requests must be in writing.**

DATE	SEMINAR	INSTRUCTOR	CPD CREDITS	TIME	MEMBER FEE	NON-MEMBER FEE	LOCATION
Saturday, September 22	<i>Getting to Know Machine Control</i> Course # 12-08-032 <i>GNSS Surveying &amp; Processing</i> Course # 12-07-045	Glenn Etienne, PE Jeffrey K. Clark, PLS	4 PDH 4 PDH	8 A.M. – 12 P.M. 1 P.M. – 5 P.M.	<b>Half Day:</b> \$110 <b>Full Day:</b> \$160	<b>Half Day:</b> \$210 <b>Full Day:</b> \$260	KY Dam Village State Park 166 Upper Village, Highway 641 Gilbertsville, KY 42044-0069
Friday, October 26	<i>KRS.322 / MTS / Code of Conduct</i> Course # 12-08-030 <i>Ethical Considerations in Underground Mine Mapping for Engineers &amp; Land Surveyors</i> Course # 12-08-031	Marco M. Rajkovich, Jr. Marco M. Rajkovich, Jr.	4 PDH 4 PDH	8 A.M. – 12 P.M. 1 P.M. – 5 P.M.	<b>Half Day:</b> \$75 <b>Full Day:</b> \$150	<b>Half Day:</b> \$125 <b>Full Day:</b> \$250	Crowne Plaza 830 Phillips Lane Louisville, KY40209
Friday, November 9	<i>Mock Trial &amp; Land Surveyor in Court</i> Course # 12-07-044	Jeffery N. Lucas	8 PDH	8 A.M. – 5 P.M.	\$160	\$260	Home Builders Association of O'boro 3515 Wathens Crossing Owensboro, KY 42301
Saturday, November 17	<i>State Plane Coordinate Systems for GPS Users</i> Course # 12-08-033	Todd W. Horton, PE, PLS	8 PDH	8 A.M. – 5 P.M.	\$160	\$260	Clarion Hotel 1950 Newtown Pike Lexington, KY 40511
Friday, November 30	<i>KRS.322 / MTS / Code of Conduct</i> Course # 12-08-030 <i>Ethical Considerations in Underground Mine Mapping for Engineers &amp; Land Surveyors</i> Course # 12-08-031	Marco M. Rajkovich, Jr. Marco M. Rajkovich, Jr.	4 PDH 4 PDH	8 A.M. – 12 P.M. 1 P.M. – 5 P.M.	<b>Half Day:</b> \$75 <b>Full Day:</b> \$150	<b>Half Day:</b> \$125 <b>Full Day:</b> \$250	Knically Conference Center WKU South Campus 654 Campbell Lane Bowling Green, KY 42101
Friday, November 30	<i>Dendrology</i> Course # 09-12-094	Stacy White, Forester	8 PDH	8 A.M. – 5 P.M.	\$160	\$260	Jenny Wiley State Park 75 Theatre Court Prestonsburg, KY 41653-9799
Saturday, December 15	<i>Best Practices in GPS Surveying</i> Course # 12-01-001	Todd W. Horton, PE, PLS	8 PDH	8 A.M. – 5 P.M.	\$160	\$260	Drawbridge Hotel & Convention Center 2477 Royal Drive Fort Mitchell, KY 41017





**KAPS**

**Kentucky Association of Professional Surveyors**

124 Walnut Street

Frankfort, Kentucky 40601

Phone: 800.866.3029 • Fax: 502.695.2667

Email: mforrest@kaps1.com



**2012 Kentucky GIS Conference  
“Changes in Latitudes”**

**FALL SEMINAR REGISTRATION FORM**

\_\_\_\_\_  
Name

\_\_\_\_\_  
Address City State Zip

\_\_\_\_\_  
Email Address

\_\_\_\_\_  
Business Phone # Home Phone # Cell Phone #

**Name of Seminar** \_\_\_\_\_

**Date of Seminar** \_\_\_\_\_

**Method of Payment:**

\_\_\_\_\_ **Check Enclosed / Amount** \_\_\_\_\_

\_\_\_\_\_ **Visa or Master Card / Amount** \_\_\_\_\_

\_\_\_\_\_  
Name as it appears on Visa/Master Card

\_\_\_\_\_  
Visa/Master Card Number V-Code

\_\_\_\_\_  
Signature Expiration Date

**Please return Registration Form and payment to:  
KAPS • 124 Walnut Street • Frankfort, KY 40601**

***Refunds:** A full refund will be granted for cancellations at least 15 days prior to the seminar. A \$25.00 penalty will be assessed for cancellations made less than 15 days prior (as determined by postmark). All requests must be in writing.*

The Kentucky Association of Mapping Professionals (KAMP) and the KY Division of Geographic Information would like to invite you to attend the 2012 Kentucky GIS Conference, September 27-28, 2012 at the Louisville Marriott Downtown in Louisville, Kentucky. **Registration is currently open at <http://kampro.org/ky-gis-conference/registration/>**

The Kentucky GIS conference remains a great value. Our full conference registration is \$250 for KAMP members, \$275 for new KAMP members (KAMP membership included) and \$300 for non-KAMP members. Single day registration is \$150 for KAMP members, \$175 for new KAMP members and \$200 for non-KAMP members.

KAMP also announces its upcoming Pre-Conference Workshops scheduled for Wednesday, September 26th from 8:30 AM – 4:30 PM. These will be held in and around Louisville, Kentucky, in association with the 2012 Kentucky GIS Conference. Our pre-conference workshops provide an opportunity for enhancing your GIS technical skills. There is a separate cost associated with the workshops (\$45-\$85 for KAMP members or \$70-\$110 general). Class sizes are limited to allow ample time for hands-on learning.

**2012 Pre-Conference Workshop Classes:**

- Web Mapping in the Cloud using ArcGIS Online
- Online GIS for Your Organization: Community Analyst, Business Analyst Online and RacerGISOnline
- Hands-On ArcGIS Server: The Workshop
- URISA Certified Workshop: LiDAR Concepts, Principles and Applications
- URISA Certified Workshop: GIS Program Management
- Custom Geoprocessing with Python Scripting in ArcGIS 10
- Obtaining, Understanding and Mapping Census Data: The US Census Geographic Support System Initiative (GSS)

**Details about Pre-Conference workshops and many other conference events can be found at <http://kampro.org/ky-gis-conference/>.**

**We look forward to seeing you at the 2012 Kentucky GIS Conference on September 26<sup>th</sup>!**



## 2012 KENTUCKY GIS CONFERENCE

Changes in Latitudes

### PRE-CONFERENCE WORKSHOPS

### PRELIMINARY PROGRAM

**When:** Wednesday, September 26th, 2012  
8:30 AM □ 4:30 PM

**Where:**

- Marriott Louisville Downtown, Louisville KY  
(<http://www.marriott.com/hotels/travel/sdfml-louisville-marriott-downtown/>)
- Southwest Campus Jefferson Community and Technical College  
[http://legacy.jefferson.kctcs.edu/general\\_info/sw\\_map.php](http://legacy.jefferson.kctcs.edu/general_info/sw_map.php)
- University of Louisville □ Center for GIS  
<http://www.ulcgis.org/>
- LOJIC  
<http://www.lojic.org/>
- Doss High School  
<http://teacherweb.com/KY/DossHS/SchoolHomePage/SDHP1.stm>

Workshop registration opens June 25.  
Go to <http://kampro.org>

#### Workshop # 1

##### Web Mapping in the Cloud using ArcGIS Online

Location: LOJIC Computer Lab  
12:30 PM – 4:30 PM  
Instructor: **Ben Koostra, P.E.**  
Level: **Beginner**; Capacity: 12  
Cost: \$45 (KAMP members); \$70 (Non-KAMP members)

This hands-on training workshop will introduce participants to Esri's ArcGIS Online, so they can learn to create and share your own web maps, connect to publicly-available map services, and upload their own data layers to share with others. It will also Use Esri's iOS or Android apps to connect to and use your maps on your phone or tablet. Configure custom web mapping applications to embed your maps on websites. Compare the capabilities of the free, personal ArcGIS Online accounts and Esri's new subscription-based organization accounts.

Ben Koostra is a consultant with Limestone & Cooper, a geospatial information and technology company.

#### Workshop # 2

##### Online GIS for Your Organization: Community Analyst, Business Analyst Online and RacerGIS Online

Location: The Audwin and Rae Helton Center for GIS Laboratory – University of Louisville, Lutz Hall, Room 224  
12:30 PM – 4:30 PM  
Instructor: **Dr. Fred L. Miller, Professor**  
Level: **Beginner**; Capacity: 22  
Cost: \$45 (KAMP members); \$70 (Non-KAMP members)

In recent years, there has been an explosion of GIS resources, capability and data deployed on the Internet, making it available to a new community of users with little GIS background or training. With powerful commercial packages such as Community Analyst and Business Analyst Online, significant analytical capabilities are at the disposal of the online user. It also includes the ArcGIS Online system, with geospatial materials that allow users to deploy existing resources, author new ones and share resulting maps with larger user communities. These communities range in size from a few co-workers in an organization, to professional groups across organizations to full access by all Internet users. This workshop provides an introduction to these systems and their capabilities as well as hands-on tutorials applied to organizational decisions. Participants may access these systems through short term evaluation subscriptions or their personal or organizational subscriptions.

Dr. Fred L. Miller is Thomas Hutchens Distinguished Professor of Marketing and Business GIS at Murray State University.

#### Workshop # 3

##### Hands-On ArcGIS Server: The Workshop

Location: Business Building Computer Lab, Room 104B  
Jefferson Community and Technical College – Southwest Campus Computer Lab  
8:30 AM – 4:30 PM  
(Light lunch provided by National GeoTech Center)  
Instructor: **Vince DiNoto**  
Level: **Beginner**; Capacity: 16  
Cost: \$45 (KAMP members); \$70 (Non-KAMP members)

This workshop will develop hands-on understanding of how to use and configure Esri ArcGIS Server to develop web and base maps. The participants will learn how to work and configure accounts such as ArcSOM and ArcSOC and will include working with relational and file databases. Participants will learn about the functionality of IIS so that maps can be viewed across the Internet.

The topics covered will include creating and utilizing basemaps as a service in ArcGIS, configuring ArcGIS Server and IIS, working with File Geodatabases and relational databases as well as creating a Web map using Esri ArcGIS Server or other Web applications such as Google Maps, Flash Builder, Silverlight, etc.

Vincent A. DiNoto, Jr. is Dean of College and Systemic Initiatives at Jefferson Community and Technical College and Professor of Physics and Astronomy.

#### Workshop # 4

##### URISA Certified Workshop: LiDAR Concepts, Principles and Applications

Location: Marriott Louisville Downtown – Room 7  
8:30 AM – 4:30 PM (Lunch on your own)  
Instructor: **Bill Emison**  
Level: **Intermediate**; Capacity: 25  
Cost: \$85 (KAMP or URISA members); \$110 (General)

This workshop will cover the following topics:

- LiDAR technology summary and how it works
- Terminology and specifications
- Airborne acquisition, mapping workflow and post processing methods
- Quality control pointers and potential error sources
- LiDAR processing software demonstration
- Future trends in the technology
- Case studies from exemplary projects

This workshop is for newcomers to the LiDAR technology who want to get a basic understanding of how the tool works. Participants will be provided with workbooks and URISA-issued certificates of attendance.

Bill Emison is a Senior Account Manager for the GeoSpatial Solutions division of Merrick & Company, a professional engineering services firm based in Aurora, Colorado (USA).

#### Workshop # 5

##### URISA Certified Workshop: GIS Program Management

Location: Marriott Louisville – Downtown – Room 8;  
8:30 AM – 4:30 PM (Lunch on your own)  
Instructor: **Peter L. Croswell, PMP, GISP,**  
Level: **Intermediate**; Capacity: 25  
Cost: \$85 (KAMP or URISA members); \$110 (General)

This URISA certified workshop will provide insights and guidelines for public agency GIS programs. It will examine the various organizational and management issues that program managers must address in order to develop and implement a successful GIS program by focusing on practical issues and challenges. Through short demonstrations and group exercises, the course material will cover all aspects of GIS project and on-going program management including:

- Strategic and implementation planning
- Budgeting and financial management
- Business case development and cost-benefit evaluation
- Team building and human resources
- Product/service procurement and vendor/contract management
- Key technical management concerns and
- Important legal and policy issues for GIS project and program management

The workshop is structured to encourage interaction and provide opportunities for attendees to share their ideas and experiences. This workshop is most appropriate for current GIS management personnel seeking to polish their skills and examine approaches to management challenges, GIS or IT users and technical staff who are moving into management roles, and/or IT management personnel who are becoming more involved with GIS program management or oversight.

Peter L. Croswell is the current President of Croswell-Schulte Information Technology Consultants. He is a former Board member and President of URISA International.

#### Workshop # 6

##### Custom Geoprocessing with Python Scripting in ArcGIS 10

Location: Business Building Computer Lab, Room 106B  
—Jefferson Community and Technical College, Southwest Campus  
12:30 PM – 4:30 PM  
Instructor: **Dr. Jun Yan**  
Level: **Intermediate**; Capacity: 16  
Cost: \$45 (KAMP members); \$70 (Non-KAMP members)

This workshop will focus on the basics of conducting custom geoprocessing with Python scripting in ArcGIS 10.0. Registrants must have

(Continued on next page)



**Workshops Continued**

**2012 Sponsors of the Kentucky GIS Conference**

**KAPS THANKS THE FOLLOWING COMPANIES FOR SPONSORING THE 2012 GOLF OUTING AND PICNIC**

*(Continued from previous page)*  
 some prior experience in computer programming and ArcGIS geoprocessing. After completing this workshop, participants will be able to (1) understand the basics of custom geoprocessing; (2) know the basics of Python scripting; (3) know the common scripting workflow; (4) write simple geoprocessing scripts in Python; and (5) create and set up script tools.

Dr. Jun Yan is an associate professor of Department of Geography & Geology at Western Kentucky University.

**Workshop # 7  
 Obtaining, Understanding and Mapping Census Data: The US Census Geographic Support System Initiative (GSS)**

Location: GIS Computer Lab - Doss High School  
 12:30 PM – 4:30 PM

Instructor: **Kevin Holmes and Erran Persley**

Level: **Intermediate**; Capacity: 25

Cost: \$45 (KAMP members); \$70 (Non-KAMP members)

This workshop is designed for GIS Technicians, GIS Analysts, and GIS Managers who want to leverage the demographic data offered by the U.S. Census Bureau. Federal, State and Local Government planning staff will also benefit the most from this workshop. The materials presented in this workshop will also be of value to academic and business analysts. At the conclusion of the workshop, participants will be able to do the following:

- Mission of the Census Bureau and the GSS Initiative
- Types of U.S. Census Bureau Data Available Online
- How to find and query tabular and geographic Census datasets
- How to download, process, and join datasets using MS Access, MS Excel, and ArcGIS Software
- How to create useful GIS data products from the U.S. Census Bureau data

Kevin Holmes is a Geographer with the Census Bureau Philadelphia Regional Office.

Erran F. Persley is a Data Dissemination Specialist with the Census Bureau based in Nashville, Tennessee.

**Workshop registration opens June 25.  
 Go to <http://kampro.org>**

**KENTUCKY ASSOCIATION OF PROFESSIONAL SURVEYORS**  
**---HOLE SPONSORS---**

**KAPS GOLF "2012" GOLF OUTING, JUNE 22, 2012**

Alliance Corp.  
 American Engineers, Inc.  
 Arnold Consulting Engineering Services, Inc.  
 Assurance Risk Managers  
 Audubon Chapter of KAPS  
 Barge Waggoner Sumner & Cannon (BWSC)  
 Barren River Chapter of KAPS  
 Bell Orr Ayers & Moore, Attorneys at Law (BOAM)  
 Bob & Bonita Fentress  
 BTM Engineering, Inc.  
 Carlson Software  
 County Surveyors Association  
 Denham-Blythe Company, Inc.  
 DLZ  
 Dyer & Associates, LLC  
 Endris Engineering, PSC  
 Engineering Design Group, Inc.  
 EnSafe  
 English Lucas Priest & Owsley, Attorneys at Law (ELPO)  
 Environmental Consulting Services, Inc. (ECSI)  
 Gary Force Toyota  
 Glass Aggregates, LLC  
 Government Strategies  
 Gray Construction  
 Gresham Smith & Partners (GS&P)  
 GRW  
 Hayes Instruments Co.  
 HDR Engineering, Inc. & Bruce Snook, PLS  
 Horizon Engineering, LLC  
 Keaton Land Surveying  
 Kerrick, Stivers, Coyle & VanZant, PLC, Attorneys at Law  
 KWM Engineering and Land Surveying  
 Land Design & Development, Inc. (LD&D, Inc.)  
 Landmark Engineering, Inc.  
 Leftwich Land Surveying, Inc.  
 McCauley & Company, Inc.  
 MLH Civil Engineers, PLLC  
 Morley and Associates, Inc.  
 Palmer Engineering  
 Photo Science, Inc.  
 Precision Products  
 Pride Engineering & Land Surveying, Inc.  
 Ragan Smith Associates, Inc.  
 Ronald Johnson and Associates, PSC  
 Scotty's Contracting & Stone, LLC  
 SE Engineering  
 Sisler-Maggard Engineering, PLLC  
 South Central Bank  
 SW Chapter of Indiana Professional Surveyors (ISPLS)  
 US Bank  
 Vaughn & Melton Consulting Engineers, Inc.  
 Walker & Associates Insurance  
 W.B. Griffin & Son Insurance Administrators  
 www.Compassionatefriends.org (Ernie Laughlin)  
 Zaenkert Surveying Essentials

**KENTUCKY ASSOCIATION OF PROFESSIONAL SURVEYORS**  
**GIFT & DOOR PRIZE SPONSORS**

**KAPS GOLF "2012" GOLF OUTING & PICNIC JUNE 22 & 23, 2012**

Alliance Corp.  
 Assurance Risk Managers  
 Barge Waggoner Sumner & Cannon  
 Bluegrass Cellular  
 Citizen First Bank  
 DDS Engineering, PLLC  
 Eastern Kentucky University (EKU)  
 Edmonton State Bank  
 Endris Engineering, PSC  
 EnSafe  
 Environmental Consulting Services, Inc. (ECSI)  
 Farmers Bank  
 Food Lion  
 Government Strategies  
 Hayes Instrument Co.  
 HDR Engineering, Inc. & Bruce Snook, PLS  
 Hibbs Engineering, Inc.  
 Home Depot  
 Houchens Industries  
 Landmark Engineering, Inc.  
 Lowe's  
 Morley and Associates, Inc.  
 Walter Bowman & Bridgestone  
 Palmer Engineering  
 Photo Science, Inc.  
 Precision Products  
 Ragan Smith Associates, Inc.  
 South Central Bank  
 Stantec  
 US Bank  
 Vaughn & Melton Consulting Engineers, Inc.  
 Walter Bowman & Bridgestone  
 Walker & Associates Insurance  
 Wal-Mart  
 Western Kentucky University

**Coverage That's Right For You**

**W.B. Griffin & Son**  
 Insurance Administrators  
 A Pearl Company

**Land Surveyors  
 Landscape Architects  
 Engineers & Architects**

[www.wbgriffininsurance.com](http://www.wbgriffininsurance.com) | 855.782.0176  
 127 Cheapside • Lexington, KY 40507-1303

**Zaenkert Surveying Essentials**  
 Bob Zaenkert  
 President

461-A Cincinnati-Brookville Rd. 1-800-262-4992  
 Okeana, OH 45053 513-738-2917  
 zaenkert@aol.com Fax 513-738-5817

---

**HRG PLLC**  
 SURVEYING & ENGINEERING  
 LAND DEVELOPMENT CONSULTANTS

416 W. THIRD ST. P.O. BOX 535  
 OWENSBORO, KENTUCKY 42302  
 PHONE 270-683-7558 FAX 270-683-9277



# Meet The Precision Allstar Team



Trimble® R8  
GNSS Rover



Trimble® R6  
GNSS Rover



Trimble® R4  
GNSS Rover



Spectra Precision®  
Epoch 50 Rover



Trimble® VX  
Spatial Station



Trimble® S8  
Robotic Total Station



Trimble® S6  
Robotic Total Station



Trimble® S3  
Robotic Total Station

## GPS Allstars

## Optical Allstars



FARO®  
FOCUS Scanner



ORI®  
Spar 300 Series



Trimble®  
TSC3



Spectra Precision®  
Ranger 3



Trimble®  
Geo 6000

### Precision Products

Offers high-tech, state-of-the-art tools for your most demanding jobs as well as the support you need to ensure your success with our Allstar team.

Take Advantage of our:

- Customized sales
- Complete support
- Factory-authorized service centers
- Certified trainers
- Local offices

## Scanning, Utility, Data Collection & Mapping Allstars

Like Us On  
facebook   
yourprecision.com  
1-800-769-7999

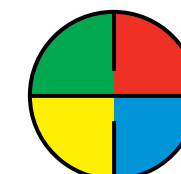

# PRECISION PRODUCTS

*Enriching the Profession*



Please save the date for the  
**2013 KAPS Annual Conference**  
February 21 - 23, 2013  
Marriott Louisville Downtown

# 2012 KAPS GOLF OUTING AND PICNIC



WITH THE DIGITAL AGE UPON US, PLEASE PROVIDE AT LEAST ONE VALID EMAIL ADDRESS!  
SEVERAL CHAPTERS COMMUNICATE EXCLUSIVELY VIA EMAIL.



Civil Engineering  
Land Surveying  
Transportation Engineering  
Materials Testing  
Land Planning  
Landscape Architecture

Quality •  
Innovation •  
Integrity •  
Satisfaction •

183 Saint Charles Street  
Bowling Green, KY 42101  
Office: 270-842-0812  
Fax: 270-842-0910  
www.landmarkengineering.net



**Vaughn & Melton**  
Engineering | Surveying

Kentucky North Carolina South Carolina Tennessee  
(800) 388-6660  
www.VaughnMelton.com

*Your Project... Our Promise*

606-573-4300 Fax: 606-573-6722  
606-573-6722 E-mail: lmainc@kih.net

**Leo Miller, PE, PLS**  
President

Leo Miller & Associates, Inc.  
Professional Engineering and Land Surveying

114 N. Second Street  
P.O. Box 488  
Harlan, Kentucky 40831



**DDS ENGINEERING, PLLC**  
LAND SURVEYING • CIVIL ENGINEERING  
LAND PLANNING • TRANSPORTATION ENGINEERING • MATERIALS TESTING

148 Chester Court, Bowling Green, KY 42103  
270-843-2247 • Fax - 270-843-9323  
www.ddsengineering.com

## Kentucky Association of Professional Surveyors

### MEMBERSHIP APPLICATION

NAME \_\_\_\_\_ SPOUSE \_\_\_\_\_

CHAPTER \_\_\_\_\_ KY P.L.S. NO. \_\_\_\_\_ LSIT NO. \_\_\_\_\_

PLEASE PLACE X TO INDICATE PREFERRED ADDRESS FOR ASSOCIATION MAILING

**RESIDENCE ADDRESS**

CITY \_\_\_\_\_ STATE \_\_\_\_\_ ZIP \_\_\_\_\_

PHONE ( ) \_\_\_\_\_ E-MAIL \_\_\_\_\_

**BUSINESS NAME**

ADDRESS \_\_\_\_\_ FAX ( ) \_\_\_\_\_

CITY \_\_\_\_\_ MOBILE ( ) \_\_\_\_\_

STATE \_\_\_\_\_ ZIP \_\_\_\_\_ E-MAIL \_\_\_\_\_

BIRTHDAY \_\_\_\_\_ WEBSITE \_\_\_\_\_

EDUCATION . . . . . (YRS COMPLETED) HIGH SCHOOL \_\_\_\_\_ COLLEGE \_\_\_\_\_

HIGHEST DEGREE \_\_\_\_\_

I HEREBY CERTIFY THAT THE STATEMENTS MADE ON THIS APPLICATION ARE CORRECT AND THAT IF ELECTED I AGREE TO BE BOUND BY THE CONSTITUTION AND BY-LAWS OF THE ASSOCIATION.

SIGNATURE \_\_\_\_\_ DATE \_\_\_\_\_

**CLASSIFICATION OF MEMBERSHIP**

<input type="checkbox"/> AFFILIATE MEMBER	\$87.50
<input type="checkbox"/> ASSOCIATE MEMBER	\$87.50
<input type="checkbox"/> COMPATRIOT MEMBER	\$87.50
<input type="checkbox"/> CORPORATE MEMBER	\$240.00
<input type="checkbox"/> FULL MEMBER	\$175.00
<input type="checkbox"/> HONORARY MEMBER	\$0.00
<input type="checkbox"/> LIFE MEMBER	\$0.00
<input type="checkbox"/> STUDENT MEMBER	\$0.00
<input type="checkbox"/> SUSTAINING MEMBER	\$87.50

**PRORATION OF DUES**  
(for New Members only)

Date of Application	Amount
January 1 through June 10	100% of Annual Dues
July 1 through December 31	75% of Annual Dues

MEMBERSHIP FEE INCLUDES CHAPTER DUES

M.C./VISA # \_\_\_\_\_

Security "V" Code (Last 3 digits on back of card): \_\_\_\_\_

Expiration Date \_\_\_\_\_

Signature \_\_\_\_\_

Referred by: \_\_\_\_\_

MAIL TO :  
KAPS  
124 WALNUT STREET  
FRANKFORT, KY 40601







www.yourprecision.com

**Serving All of Kentucky With 3 Convenient Locations!**

Central Kentucky:  
LOUISVILLE (502) 459-1900

Eastern Kentucky:  
LEXINGTON (859) 225-3477

Western Kentucky:  
EVANSVILLE, IN (812) 434-9900



**We Are A Proud Supporter of KAPS!!!**

